



SOLUTION FOR HEAVY LOADS

www.shlsolution.com

A COMPANY OVERVIEW

SHL SHL originates from the ten-years' experience of its board members and of its management which led to the acquisition of highly specialized and trained staff able to handle prestigious projects.

The union and the synergy of these experiences and the constant search of engineering solutions have created a very high level of expertise on handling and project forwarding sectors.

The constant and tireless search of our engineering team has led SHL to achieve the most innovative solutions during the study phase of the project, to offer a truly turnkey service in every management and coordination step of the project. Our focus is the search of specialisation.

Our mission is the study of customized solutions on specific needs. We start from engineering step studying specific territories to activate the most suitable partnership with the goal of providing quotation with excellent cost efficiency also starting from the offer step.

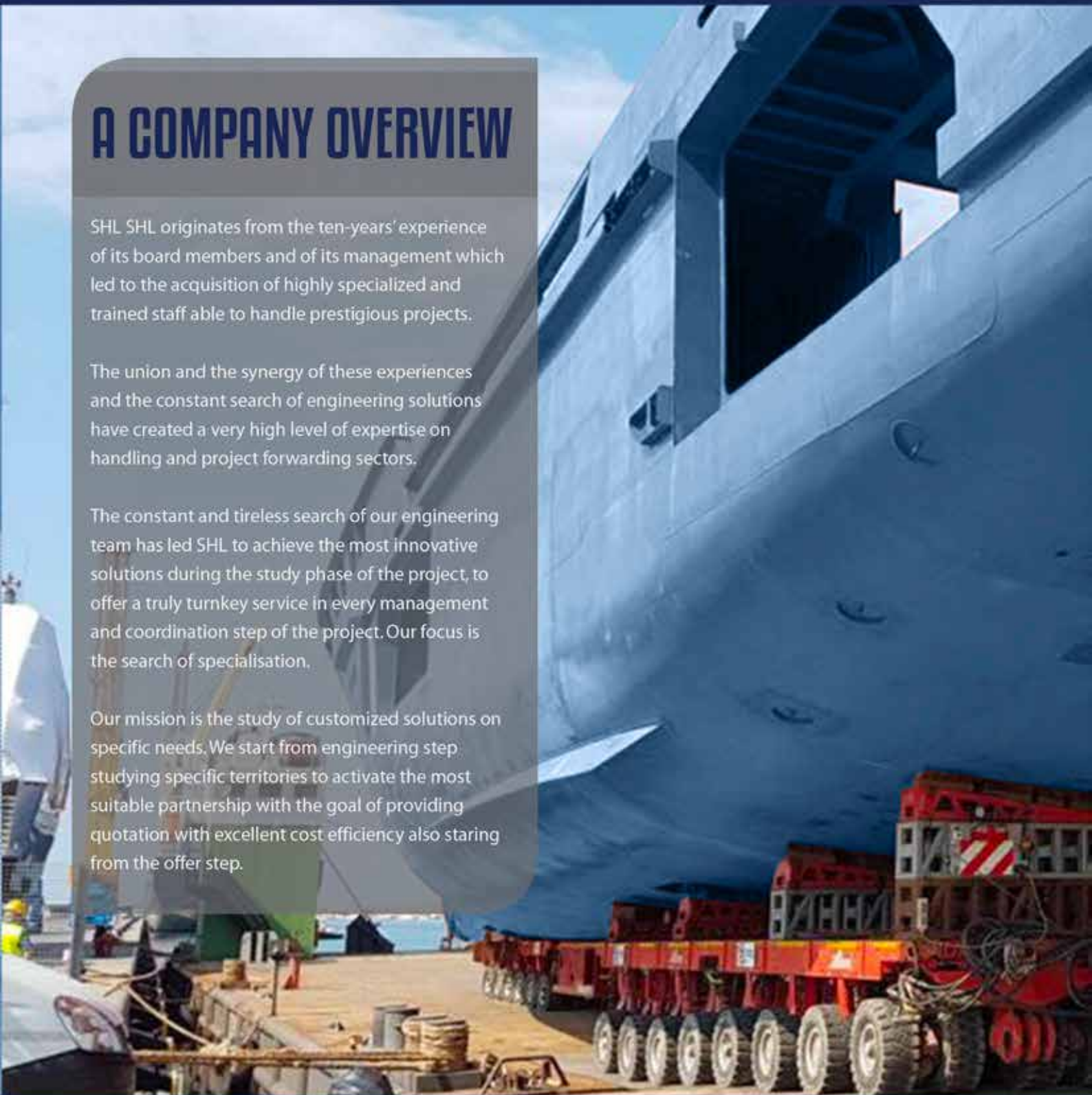

BUSINESS UNIT

PROJECT FORWARDING

The services offered by SHL organisation include, among others the complete door-to-door transport of project cargo and international Freight Forwarding. The activity of "project transport" mainly includes the delivery of material for the construction of complete plants. During the construction of a plant, whether you are transporting by normal trailers, ocean going vessels, carrying out container deliveries or large reactors, every single activity involving the movement of any single item has its relevant importance!! "No difference, same target: safe and professional performances, timing and competitive rates".

We fully focus on identifying our client's specific needs and tailoring unique solutions to suit and solve all your requirements. We see ourselves as an extension of our customers in their respective supply chains, in order to provide the best in terms of both cost and service.

When you're still wondering how to move it, we've already got something in mind. From project forwarding, general cargo services, air freight and customs clearance to inland transportation, warehousing and consulting, our experienced specialists and strong partners all over the globe have everything it takes to make sure that when it comes to moving, nothing stands in your way. Sit back, relax and watch us take care of your project. That's what we call providing our clients with turnkey solutions.

SHL is present on a worldwide basis through established network of qualified agents.

SHL coordinates and controls all the shipping / documentation stages: - Issuing all documentation - Transport planning for all modes of transport- Continued Status reports on door to door deliveries through company's traffic department and project coordinator

- Sea Charter services - Custom clearing - Insurance - Storage and Warehouse management - Additional value added Services - Customized solutions



ADDITIONALS, OFFERED BY SHL...

- Coordination skill to find new solutions and being flexible in fitting with the continuous evolutions of the shipment/project
- Technological Know how; -Dedicated Project manager from the beginning to the end of project SHL is one of the few companies in the world that can offer at the same time, Heavy Lifting, Handling and Project Logistics services.

This combination enables SHL to provide our clients with a unique "Total Supply Chain" concept that keeps coordination and responsibility in the hands of one company. One contact, less interfacing risks, reduced costs and better coordinated services!!



BUSINESS UNIT

HEAVY TRANSPORT/HANDLING AND LIFTING



This Business Unit includes lifting, positioning, assembly and handling services in which the Company has specific skills that provide the end client with excellent quality performance in compliance with safety standards.

SHL is specialized in the transport, lifting and handling of major heavy items. SHL can offer specialist services, which deal with oversized and over-weight cargo that cannot be transported or lifted by conventional methods.

These operations cover on a turn-key basis all operations from the conceptual engineering design provided in-house, through to positioning onto foundation including any lifting and logistics operations.

On a case by case basis, SHL studies each operation to determine the safest and most technically and economically advantageous solution. The engineering department, in close contact with the surveying team, designs the transport convoy or method of lifting according to the job-specific parameters.

SHL in-house department is continuously upgrading and up-dating its know-how and its technological facilities (cad drawings, 3D simulation movies) in order to face each transport and lifting operation with a safely and professional approach.

SHL is owner of gantry and screw jacks systems to conduct heavy-lift assembly and erection activities for the final positioning of turbine-generators sets, heavy presses, boiler sections, transformers, storage tanks...

River and maritime activity are performed by our partners who own geared heavy lift vessels, local barges and tugboats.



BUSINESS UNIT

HEAVY TRANSPORT/HANDLING AND LIFTING - ASSETS

EQUIPMENTS AVAILABLE:

N° 28 axles Self-Propelled Modular Trailer (SPMT) Schuerle: N° 2 module composed of 6 axles + n° 4 module of 4 axles + n° 1 PPU little + n° 1 PPU big, combinable with each other in various configurations. Self-propelled modular transporters (SPMTs) are multi-axle trailers designed for the transportation of large and heavy cargoes. The SPMT's are designed in modular construction and can be coupled side to side and end to end, or remote units can be operated as a single transporters via radio controls. The SPMT's consist of a very strong and rigid chassis, which also acts as a load-carrying platform to which wheel bogies are attached in pairs to form the required length of transporter. Each wheel bogie consists of two rubber tyred wheels and is rigidly fixed to the chassis by a hinged elbow joint, which is supported on hydraulic rams. This hydraulic ram acts as the suspension for the SPMT and also provides the lifting capability. Attached to the end of the SPMT is a Diesel driven power pack, which provides hydraulic power to the various functions of the SPMT.

Skidding System : Skidding systems are designed to make safe and precise horizontal movements, and as such are an effective means of moving plant and structures in confined or restricted environments. The movement equipment has hydraulic skid-shoes with stainless steel bases which move over low-friction blocks laid into steel skid-tracks in an extend/retract sequence. We operate skidding systems to suit a wide range of capacities, with the option of combining a number of skid-shoes to create the most suitable system for moving complex loads. The integral hydraulic cylinder of the skid-shoes can be interlinked to provide a hydraulically compensated suspension system.

N° 2 set of «gantry cranes» Rigger: capacity each. 600 ton, can work in single (2 legs) or combined (4 legs), reaching a lifting capacity at the first extension of 1.000 ton. This system is a mobile, self-propelled, variable height, hydraulic lifting frame. It is primarily controlled from a remote, self contained power module, that is positioned away from the gantries. The gantries are designed to be operated on track. The Gantry Crane makes possible to carry out lifts where the usual telescopic cranes are not able to operate: particular examples are the industrial production areas, sheds with binding heights or limited spaces and all areas where discriminating is the operational space in general.

Treteaux / Screw Jacks : The heavy duty screw jacks are mechanical linear actuators able to lift up to 500 tons (4 units). They are generally used to move the work piece to a comfortable height for assembly or machine operators, but also for loading and offloading it to and from transportation equipment. The jacking units can be connected by spreader beams or simply to the jacking wings of the vessel to lift or lower. Each unit is composed by an electric motor, a gear speed reducer, the screw (or worm shaft) and a worm gear all contained in a solid and stable steel frame. The screw jacks enable to move heavy loads slowly, accurately and safely. The advantage of such system is the simplicity.

Hydraulic Unit (series EVO) and various jacks

BUSINESS UNIT ENGINEERING

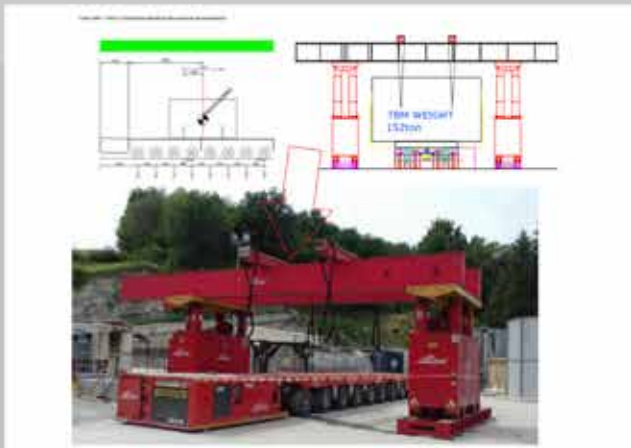

SHL engineering division" is a "spin-off department" created to support the continuous requests for dedicated engineering know-how. During these last years the requests of the customers have not only been connected to SHL long-standing typical activity but also related to the matters and problems during the modularized plant construction pre-planning phase for the definition of civil requirements and logistics engineering". Moreover there is a bigger and bigger involvement of engineering know-how within the most challenging clients construction requirements. Engineering is not only the capability to make complex structural calculations but also the ability to choose for the most effective technical solutions and the appropriate equipment and means of transports and lifting, considering all the aspects concerning safety, quality and environment, reliability of the service offered, budget and activity planning, in order to satisfy clients requirements.

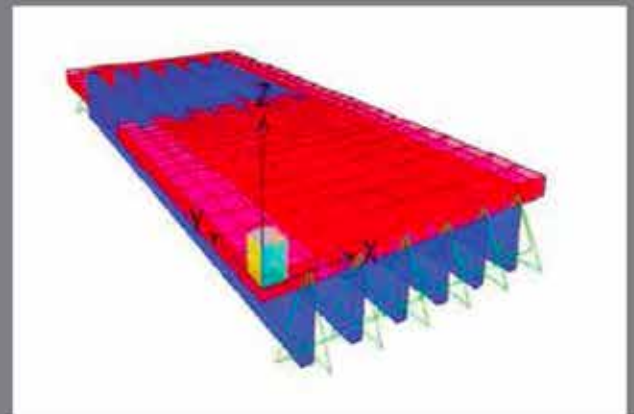

BUSINESS UNIT

PROJECT LOGISTICS AND FREIGHT FORWARDING



SOLUTIONS TO FIT ANY SIZE.

Whatever your consignment, whether small spare parts or oversized plant, SHL will carry it securely to its destination abroad.

Our project forwarding services include:

- Global network of partners
- Specialist know-how for all freight types
- Personal, needs-specific counselling
- 24/7 service

HEAVY TRANSPORT/HANDLING AND LIFTING

WE KEEP INDUSTRY MOVING.

Whatever your consignment, whether small spare parts or oversized plant, SHL will carry it securely to its destination abroad.

Our project forwarding services include:

- Global network of partners
- Specialist know-how for all freight types
- Personal, needs-specific counselling
- 24/7 service



ENGINEERING

ACTING AS A REAL PARTNER:

During the feasibility phase SHL is willing to act as a real partner, working side by side with the client and proposing alternative cost-saving solutions. During the bid stage, SHL Engineering Department supports the Commercial Management in identifying the most suitable means and equipment for the execution of the projects, issues the Method of Statements and drawings, analyses the Technical Specifications of the Client and the Technical aspects of the offer/tender.





SOLUTION FOR HEAVY LOADS

SHL S.p.A.

Sede Operativa e Legale: Via Benjamin Franklin, Quartiere Spip, n° 31 - 43122 Parma (PR) - Italia

Telefono +39 05211478816 - Fax + 39 05211478820

E-mail: info@shl-solution.com

Sito Internet: <http://www.shl-solution.com>